

Farm for Sale

First Mid Ag Services - Farm Brokerage

First Mid

AG SERVICES



Yarbrough Trust Farm

18.05 acres in Coles County

Offered at \$12,000/acre (\$216,600.00)

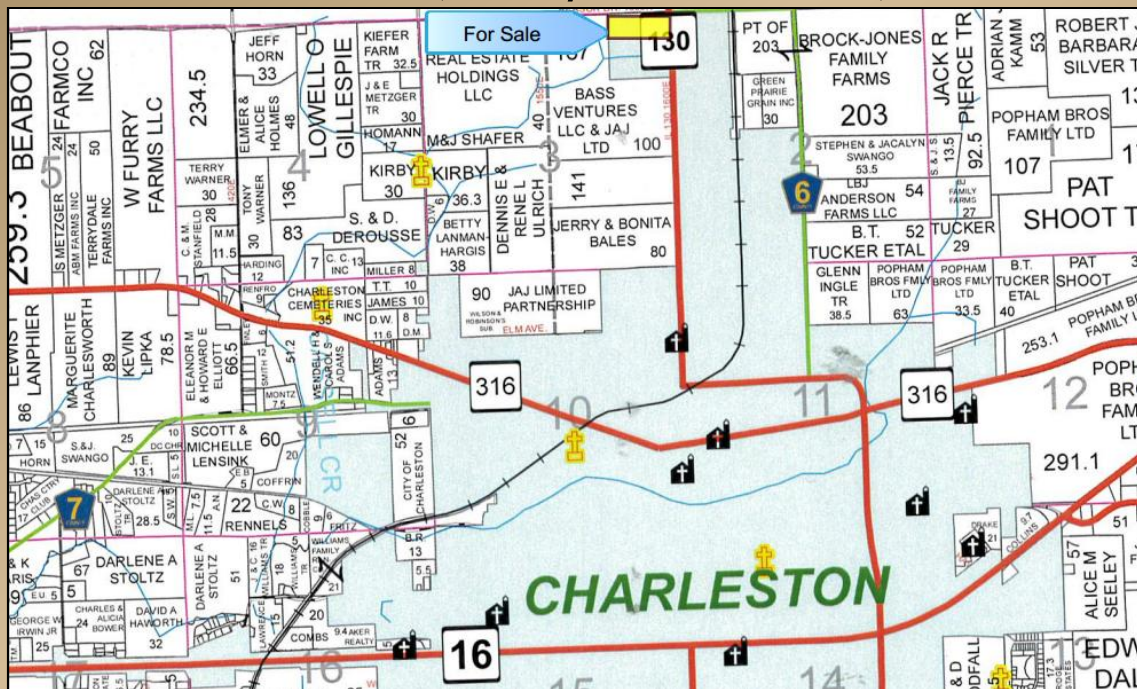

Material is subject to the Coles County Farm Bureau's copyright

Property Latitude/Longitude: 39.520564°, -88.177575°

Contact Information

Ron Pierce, Listing Broker – 217-345-8312

Kyle Ogden, Managing Broker – 217-258-1561
kogden@firstmid.com

First Mid Ag Services
500 W Lincoln Ave, Charleston, IL 61920
(Office) 217-345-8312

Highlights

- Commercial Development Potential
- Zoned I2 for Heavy Industrial Use

Real Estate Tax Information (2017 Payable 2018)

PIN	Acres	Assessed	
		Value	Tax
02-1-00079-000	18.05	\$8,316	\$743.78

Disclaimer: The information contained in this brochure is considered accurate. It is subject to verification and no liability for errors or omissions is assumed. There are no warranties, expressed or implied, as to the information herein contained, and it is recommended that an independent inspection of the property be made by all buyers. **Agency:** First Mid Ag Services, a division of First Mid Wealth Management Company, its agents, and representatives are exclusive agents of the Seller.

Farm for Sale

Aerial Map, Soil Information

 **First Mid**

AG SERVICES

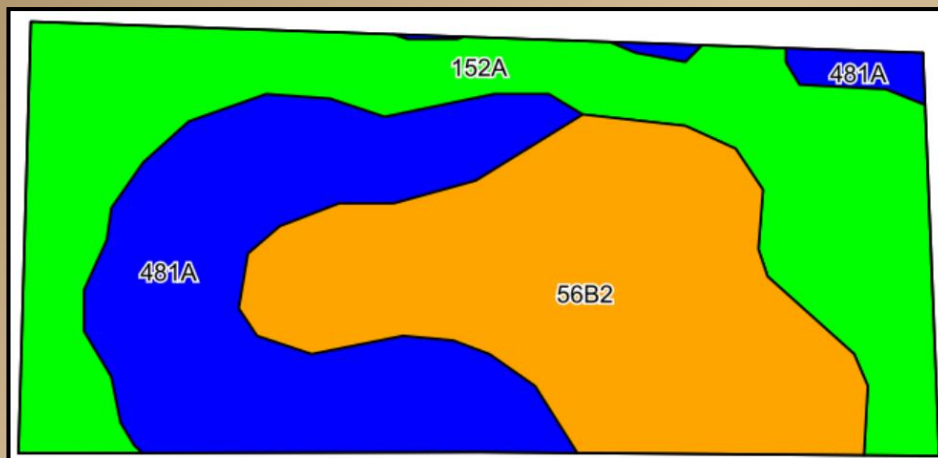

Aerial Photo & Soils data provided by AgriData, Inc. Lines drawn are estimates.

Farm Average PI: 134.2

Tillable Acres: 18.29

Soil	Soil Description	Acres
152A	Drummer Silty Clay Loam	6.66
56B2	Dana Silt Loam	6.25
481A	Raub Silt Loam	5.41

FSA & Soils data provided by AgriData, Inc. Lines drawn are estimates.

General Terms:

The buyer shall provide a 10% down payment upon entering into a contract. All mineral rights owned by the seller will be conveyed. The buyer shall receive possession of the property at closing subject to the current farm lease. The farm lease is currently open for 2019. Buyer will receive a credit for the 2018 property taxes payable in 2019 and shall be responsible for all future taxes.

Ron Pierce, Listing Broker
Phone: 217-345-8312

 **First Mid**
AG SERVICES

Disclaimer: The information contained in this brochure is considered accurate. It is subject to verification and no liability for errors or omissions is assumed. There are no warranties, expressed or implied, as to the information herein contained, and it is recommended that an independent inspection of the property be made by all buyers. **Agency:** First Mid Ag Services, a division of First Mid Wealth Management Company, its agents, and representatives are exclusive agents of the Seller.