

FARMS FOR SALE FROM FIRST MID AG SERVICES

January 7, 2022

158.69 Acres+/- (B-482)
 2 Tracts-South of Gridley
 North of Lake Bloomington
 December 21st Auction
 Hybrid Live/Online Format

160 Acres+/- (K-129)
 Krischel Farm in 2 Tracts
 southeast of Wenona/east
 of Rutland. Planned
 February 10th Auction

197 Acres+/- (B-494)
 Chenoa-Ashkum Soils
 \$2,000/acre
Sale Pending

79.56 Acres+/- (B-482)
 North of Lake
 \$1,000/acre
Sale Pending
 November 12th Auction

380 Acres+/- (P-125)
 Prime to undulating cropland
 Planned March 1st Auction –
 In person & Online Bidding!

78.04 Acres+/- (B-498)
 Tillable, CRP, timber, west of
 Kappa/SW of El Paso
 Feb. 9th Auction in El Paso

74 Acres+/- (B-488)
 On IL 54 @Bellflower
 Listed at \$14,250/acre.

256 Acres+/- (B-497) Maurer Farm
 North of Danvers in 4 Tracts with
 Shed & Grain Storage
 February 22nd Auction 1 PM

76.28 Acres+/- (M-36)
 1 Tracts– Class A Soils
 Planned February 23rd
 Auction

99.8 Acres+/- (B-495) Grusy Farm
 Class A Soils Dry Grove Twp. NW of
 Normal. February 22nd Auction 10AM

79.51 Acres+/- (S-67) Class A Soils
 East of Riverton
 February 16th Auction 10AM

959 Acres+/- (B-488) 16 Tracts
 Tillable Cropland & Recreational use
 All in 1 lot @ \$1,000/acre
SOLD!
 Auctioned by First Mid Ag Services
 with online bidding options

900.36 Acres+/- (M-33) Tillable &
 Timber 1 mi. SW of Mill Shoals off
 I-64. Listed @ \$5,000/acre.
Sale Pending

212 Acres+/- (M-23) Timber &
 Tillable on north side of Harrisburg.
 Trophy Buck Hunting
 Listed @ \$6,000/acre.

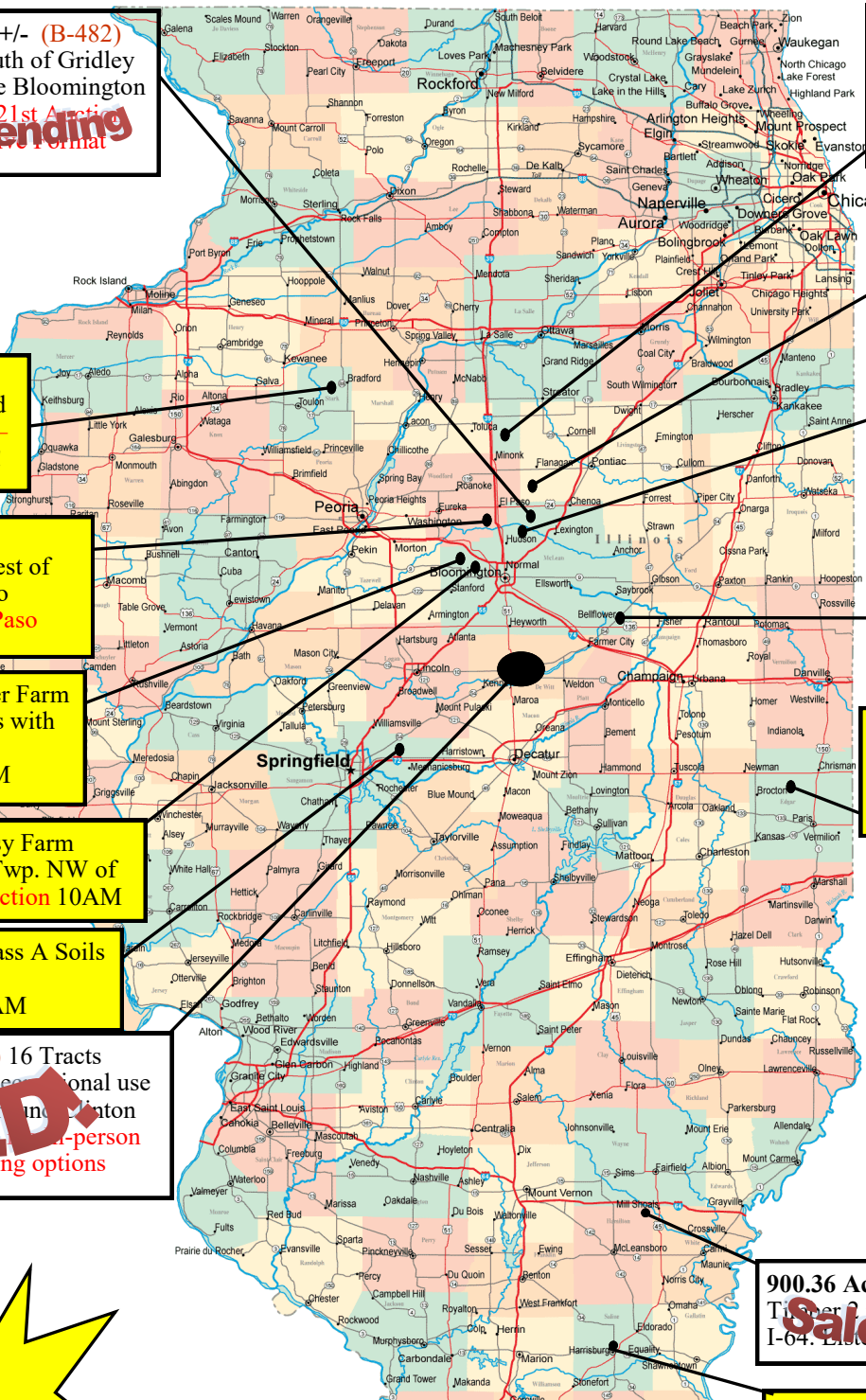

David Klein, ALC—Designated Managing Broker & Auctioneer
 See our website www.firstmidag.com for details
 #6 Heartland Dr. Bloomington 309-665-0955 Principal Office