

PROPERTIES FOR SALE FROM FIRST MID AG SERVICES
April 2, 2024

Commercial Grain Elevators at Rollo, IL (B-474)
 Call Garrett Schoenholz for Details. \$1,365,000 for east and \$296,000 for west of RR Tracks. Call 815-757-7721

80 Acres+/- (B-561) 3 miles north of Rock Island, IL
SOLD!

81.295 Acres+/- (B-568)
10AM Feb 29th Auction!
 Virtual Online
 Swanda Twp. McLean Co.
Sale Pending

122.16 Acres+/- (B-567) SE corner of Bloomington on Ireland Grove Rd.
 Listed at \$37,250/acre

75.44 Acres+/- (D-144)
10AM March 14th Auction!
 Timed Online Only
Sale Pending
 Class A 141.3 soil PI!

79 Acres+/- (S-69) 10AM March 7th Auction!
 Live In Person & Online
 Christian Co. & Taylorville
 Class A 142 soil PI!
Sale Pending

160 Acres+/- (D-146) 3.5 miles SW of Macon, Class A soils
 136.8 PI
Sale Pending

80 Acres+/- (B-566)
 McLean Co. SE of
SOLD!
 March 10

158.5 Acres+/- (B-569) 7 miles east of Bloomington
 10.6 soil PI. Leased for
Sale Pending
 Listed at \$13,900/acre.

161.94 Acres+/- (B-565) south of Downs McLean
 22.2 Adjacent Tracts
SOLD!
 Feb 29

106.2 Acres+/- (M-59)
 Feb. 13th Virtual
 Live Online Auction
 10.4 M east of Tazewell
SOLD!

550 Acres+/- (M-60)
MARCH 19th Virtual Live Online Auction!
Sale Pending
 White Heath in 6 Tracts

79.5 Acres+/- (B-560) 8 miles SE of Canton. Class A soils
 DeWitt Co. Listed at
Sale Pending

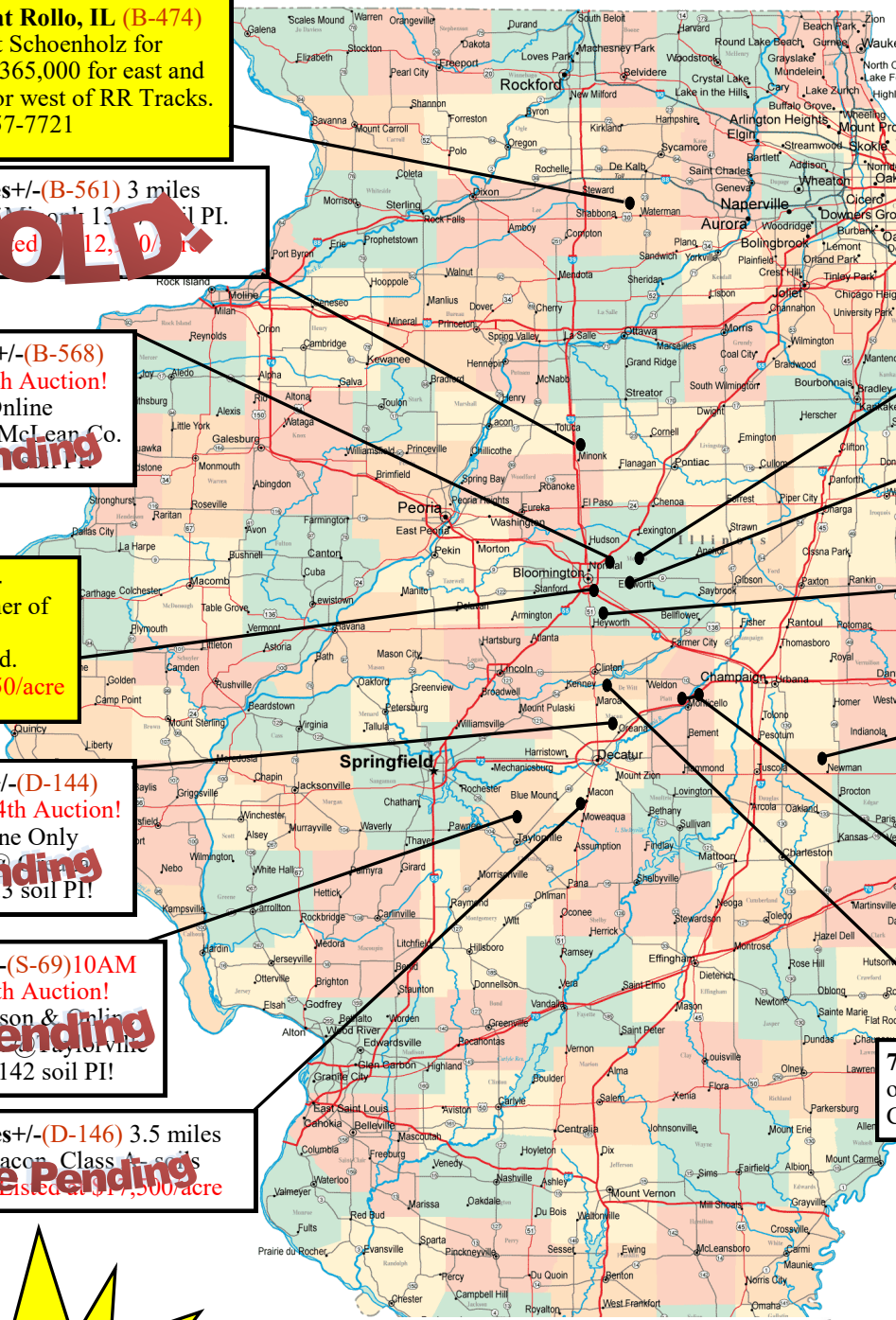

AG SERVICES



David Klein, ALC—Designated Managing Broker & Auctioneer - Justin Wheeler, Auctioneer

See our website www.firstmidag.com for details

#6 Heartland Dr. Bloomington 309-665-0955 Principal Office